

# NOCCHI DOMINATOR 4 PLUS

## ELECTRIC SUBMERSIBLE MULTI-STAGE CENTRIFUGAL PUMP FOR FRESH WATER Ø 4"



DOUBLE MECHANICAL SEAL, HYDRAULIC SYSTEM PARTICULARLY RESISTANT TO SAND CORROSION, INTEGRATED CHECK VALVE

DOMINATOR 4 PLUS submersible pumps with double mechanical seal are ready to use and install in traditional wells, water deposits, collection tanks, fresh water courses, lakes etc. Supplied with nylon suspension cord (20 m).

- Maximum liquid temperature: 40°C.
- Maximum immersion below water level: 17 m.

### MOTOR

- Dry motor with stainless steel body cooled by pumped liquid.
- Protection rating IP 68.
- Insulation class F.
- Single phase power supply with permanently activated capacitor.
- Thermal cutout protection incorporated in motor winding.
- Fully insulated cable connection chamber.
- Self-lubricating ball bearings.
- Rotation speed 2850 rpm.
- Suitable for continuous duty.

### APPLICATIONS

- Lifting from traditional wells.
- Installations in tanks in the home for pressurization systems.
- Small automatic garden irrigation systems.
- Gravity irrigation systems.

### APPLICATION DATA

- Type of liquid: clean water without suspended solid bodies or abrasive material.

**NEWS 2015**  
PENTAIR



### TABLE OF MATERIALS

Componente	Materiale	
1	Check valve	Thermoplastic with NBR o-ring - integrated
2	Pump body	Stainless steel Europe: EN10088-1 X 5 CrNi 1810 (1.4301) Usa: AISI 304
3	Mechanical seal - stationary part oil chamber	Aluminium oxide / NBR
4	Mechanical seal - rotary part oil chamber	Stainless steel Europe: EN10088-1 X 5 CrNi 1810 (1.4301) Usa: AISI 304 / NBR / Carbon graphite resin impregnated
5	Mechanical seal - stationary part	Aluminium oxide / NBR
6	Mechanical seal - rotary part	Stainless steel Europe: EN10088-1 X 2 CrNiMo 17-12-2 (1.4404) USA: AISI 316 / NBR / Carbon graphite
7	Motor shaft	Wet side - Europe: EN10088-1 X 8 CrNiS 18-9 (1.4305) USA: AISI 303 / Motor side - carbon steel
8	Diffuser cap	Polycarbonate with stainless steel wear insert Europe: EN10088-1 X 5 CrNi 1810 Usa: AISI 304 (1.4301)
9	Diffuser	Polycarbonate with ceramic wear insert
10	Impeller	Acetal resin
11	Bushing	Stainless steel Europe: EN10088-1 X 8 CrNiS 18-9 (1.4305) USA: AISI 303 with ceramic coating
12	Bearing	Self lubricating Nylatron®
13	Suction filter	Stainless steel Europe: EN10088-1 X 6 Cr 17 (1.4016) USA: AISI 430
14	Base	PPO - Noryl™ GFN 2
-	Power cable	Type H07 RN-F - length 20 m
-		Thrust ring inserted in each stage

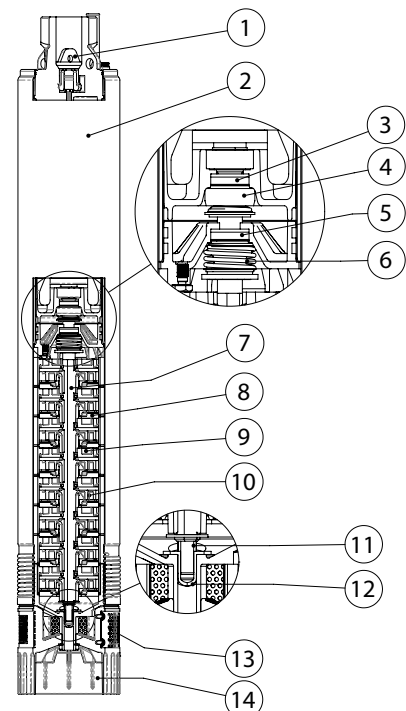

# NOCCHI DOMINATOR 4 PLUS

ELECTRIC SUBMERSIBLE MULTI-STAGE CENTRIFUGAL PUMP FOR FRESH WATER Ø 4"

## HYDRAULIC PERFORMANCE

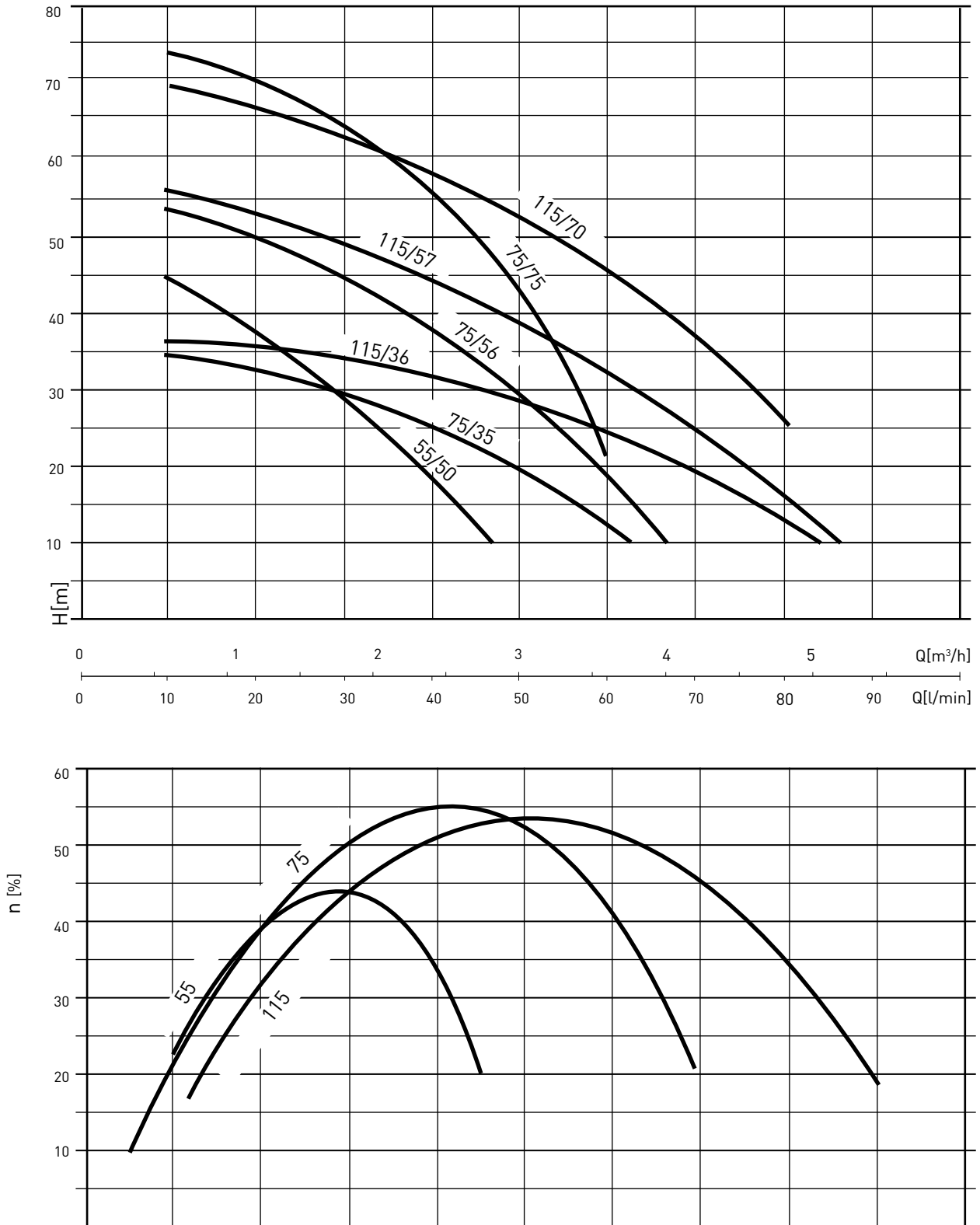

MEI  $\geq 0.4$  - MEI reference  $\geq 0.70$  - The reference efficiency information is available on the website: [www.europump.org/efficiencycharts](http://www.europump.org/efficiencycharts)

# NOCCHI DOMINATOR 4 PLUS

ELECTRIC SUBMERSIBLE MULTI-STAGE CENTRIFUGAL PUMP FOR FRESH WATER Ø 4"

## PERFORMANCE TABLE

MODEL	Motor output (P2)		Power Motor (P1)		VOLTAGE (V)	In (A)	µF	Stages	Q	l/min m³/h	0	20	40	60	80	
	HP	kW	HP	kW							0	1.2	2.4	3.6	4.8	
DOMINATOR 4 PLUS 55/50 M	0.75	0.56	1.1	0.8	1 ~ 230	3.8	16	6	m.c.a./m.w.c.	50	38.7	17				
DOMINATOR 4 PLUS 75/35 M	0.50	0.35	0.80	0.60	1 ~ 230	3	12.5	5		35	33	26	11			
DOMINATOR 4 PLUS 75/56 M	0.80	0.60	1	0.75	1 ~ 230	3.3	16	8		56	48.9	38.1	19			
DOMINATOR 4 PLUS 75/75 M	0.95	0.7	1.5	1.1	1 ~ 230	5	20	11		75	70	53	21.6			
DOMINATOR 4 PLUS 115/36 M	0.55	0.40	1	0.75	1 ~ 230	3.5	12.5	5		36	35	32	25	13		
DOMINATOR 4 PLUS 115/57 M	1	0.8	1.50	1.10	1 ~ 230	5	16	8		57	52	44.4	31.5	16.6		
DOMINATOR 4 PLUS 115/70 M	1.1	0.8	1.8	1.3	1 ~ 230	6	20	10		70	65	59	45.4	27		

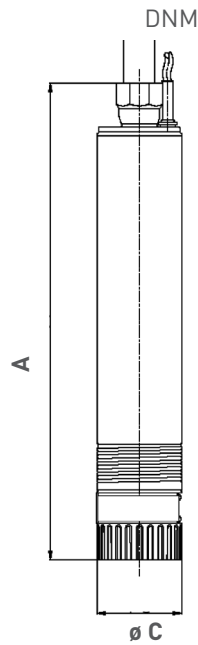

## OVERALL DIMENSIONS AND WEIGHTS

MODEL	Dimensions (mm)				Weight (kg)
	A	Ø C	Free clearance	DNM	
DOMINATOR 4 PLUS 55/50 M	549	98	2 mm	1"1/4	10.4
DOMINATOR 4 PLUS 75/35 M	560	98	2 mm	1"1/4	10.2
DOMINATOR 4 PLUS 75/56 M	643	98	2 mm	1"1/4	10.8
DOMINATOR 4 PLUS 75/75 M	760	98	2 mm	1"1/4	12.5
DOMINATOR 4 PLUS 115/36 M	560	98	2 mm	1"1/4	10.2
DOMINATOR 4 PLUS 115/57 M	643	98	2 mm	1"1/4	10.8
DOMINATOR 4 PLUS 115/70 M	732	98	2 mm	1"1/4	12.5